

Broadband Frequency Divider by 2

0.1-26.5GHz, SMA Female

2023-10-5



Description:

AT-FD2-26S is low noise divide-by-2 frequency divider with SMA female input connector. This device operates from 100MHz to 26.5GHz with a single 5V supply.

This divider offers SSB phase noise of -152dBc/Hz at 100kHz, which helps the user maintain excellent system noise performance. Differential input and differential output is available according to request.

More information, visit www.atmicrowave.com

Feature

- ✓ Wideband coverage
- ✓ Low SSB phase noise
- ✓ Low current
- ✓ Small Size

Application

- ✓ 5G Systems
- ✓ Raday System
- ✓ Test Equipment
- ✓ ROF (RF Over Fiber)
- ✓ Communication System

Electronical Specifications:

Parameter	Min	Typical	Max
Input Frequency Range		0.1-26.5GHz	
Input Power	-10dBm	0dBm	+8dBm
Divider Rate		/2	
Output Frequency		0.05-13.25GHz	
Output Power	-6dBm	-3dBm	
Vdd		+5V	+8V
Current		35mA	
Spec Temp		25C	





AT-FD2-26S

0.1-26.5GHz Frequency Divider by2

Mechanical Information

Item	Description
Input Port	SMA Female
Output Port	SMA Female
Case Material	Copper
Finish	Gold Plated
Weight	50g
Size:	See outline

Absolute Maximum Ratings Table

Parameter	Value
Power Supply	+13V
RF Power Handling	+15dBm
Operating Temperature	-40 to 85C
Storage Temperature	-55 to +125C

Notes:

1. Datasheet may be changed according to update of MMIC, Raw materials , process, and so on.
2. This data is only for reference, not for guaranteed specifications.
3. Please contact AT Microwave team to make sure you have the most current data.



Test Data (25C)

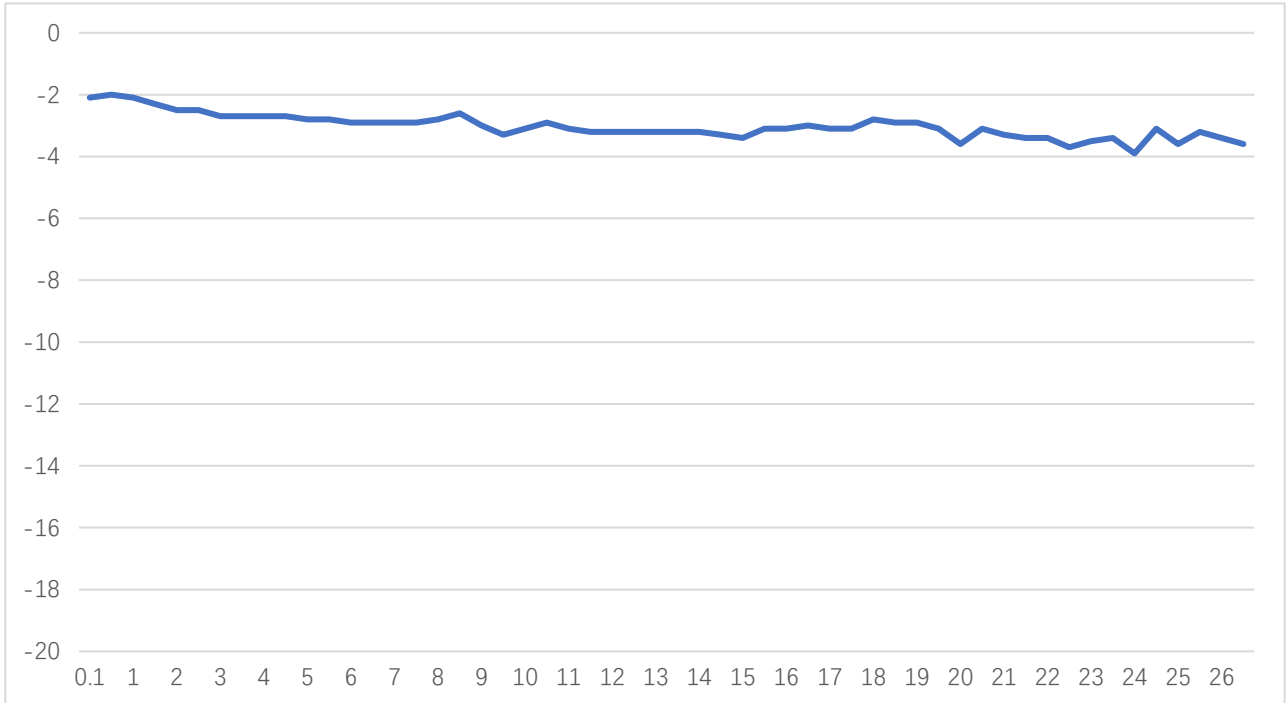

/2 Output Power vs Input Frequency

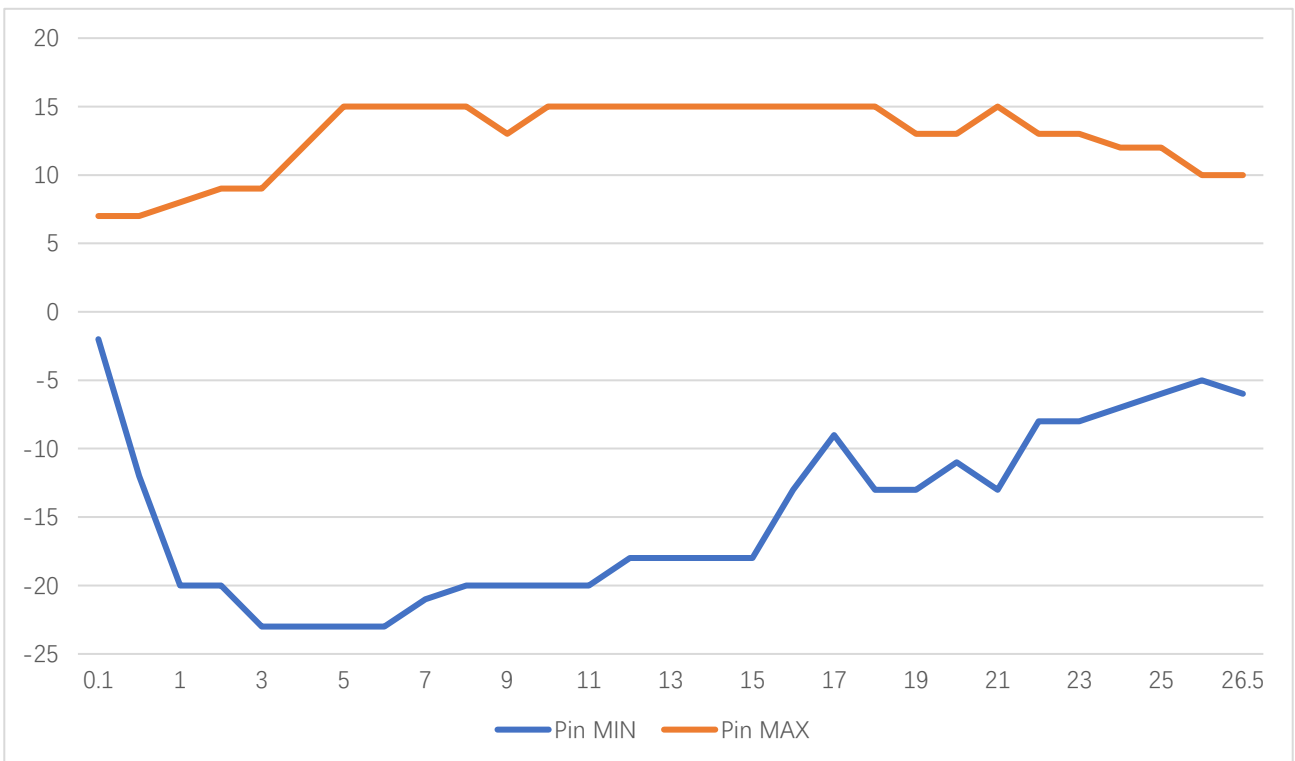

Input Power Window vs Input Frequency



Dimension: (mm)

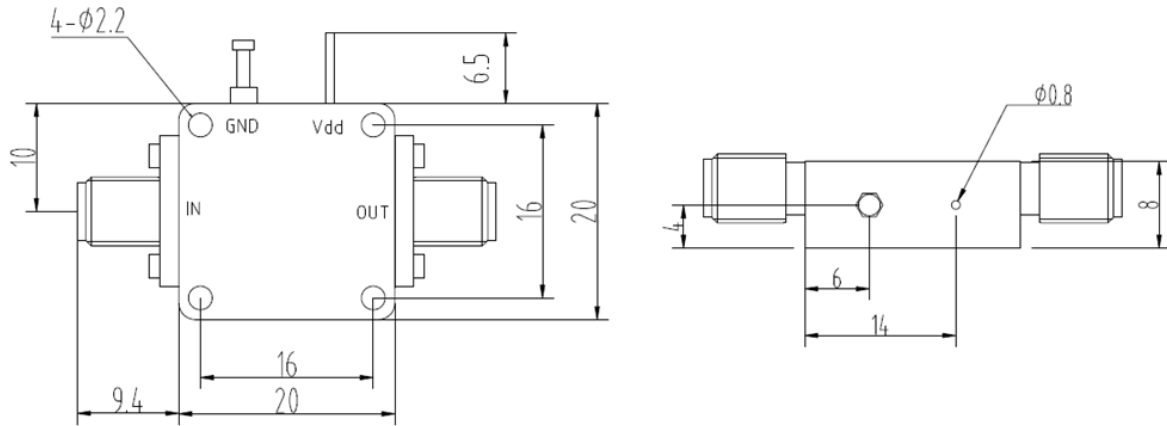

	<26.5GHz	<40GHz	<50GHz	<67GHz
Connector	SMA	2.92mm	2.4mm	1.85mm
Lenth of a	9.4mm	9.5mm	10.8mm	11.3mm

Note: Female Default. Contact with us for other types.

