

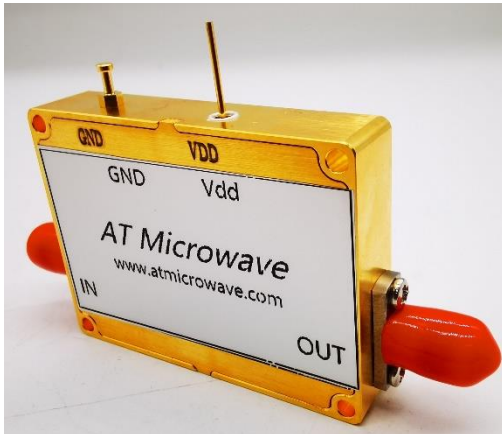

AT-AM2-2040-15L

Active Multiplier x2, 20-40GHz Pout=+15dBm

Active X2, 20-40GHz Broadband



Description:

AT-AM2-2040-15L is a broadband frequency doubler. The doubler has an input frequency of 10-20 GHz with a typical output +15dBm from 20-40GHz with low input power +5dBm.

The integrated input and output buffers deliver high output power at a low drive level. The doubler also has a typical harmonic suppression. The input port is SMA female, and the output is 2.92mm Female. Other port configurations are available under different requirement.

More information, please visit www.atmicrowave.com

Feature

- ✓ Frequency: 20-40GHz
- ✓ Pout: +15dBm typical
- ✓ Input: 10-20GHz
- ✓ Low Harmonics

Application

- ✓ 28/39GHz 5G Communication
- ✓ Test Equipment
- ✓ ROF (RF Over Fiber)
- ✓ Radar System

Electronical Specifications:

Parameter	Min	Typical	Max
Input Frequency	10GHz		20GHz
Input Power	0	+5dBm	+10
Multiplier Factor		X2	
Output Frequency	20GHz		40GHz
Output Power	+12	+15dBm	
1 st /3 rd Harmonic Suppression		-25dBc	
Drain Voltage		+5V	+8V
Current		300mA	
Spec Temp		25C	

Shanghai AT Microwave Limited

Tel:021-6229 1233

Email:sales@atmicrowave.com

www.atmicrowave.com





AT-AM2-2040-15L

Active Multiplier x2, 20-40GHz Pout=+15dBm

Mechanical Information

Item	Description
Input Port	SMA Female
Output Port	2.92mm Female
Case Material	Copper
Finish	Nickel Plated
Weight (Without Heatsink)	80g
Size:	45x34x8.5mm

Absolute Maximum Ratings Table

Parameter	Value
Drain Supply	+13V
RF Input Power	+20dBm
Operating Temperature	-20 to +70C
Storage Temperature	-65 to +150C

Note: -40 to 85C operating Temp range is available according to request.

Notes:

- ✓ Datasheet may be changed according to update of MMIC, Raw materials , process, and so on.
- ✓ This data is only for reference, not for guaranteed specifications.
- ✓ Please contact AT Microwave team to make sure you have the most current data.
- ✓ Always pay attention to the temperature of the case, heatsink and fan are required if case temperature exceeds over 50C.





AT-AM2-2040-15L

Active Multiplier x2, 20-40GHz Pout=+15dBm

Test Data (25C)

Please note that test curves will vary slightly from unit to unit.

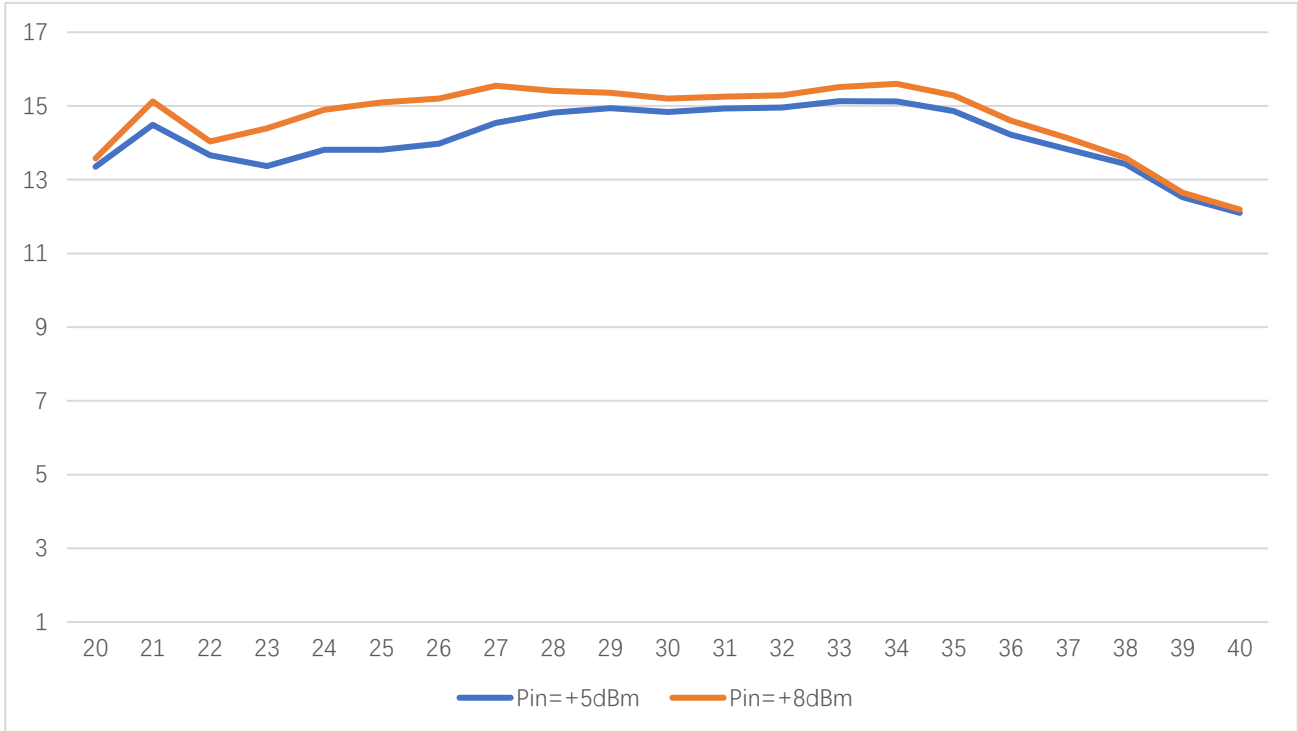

Pout Vs Frequency

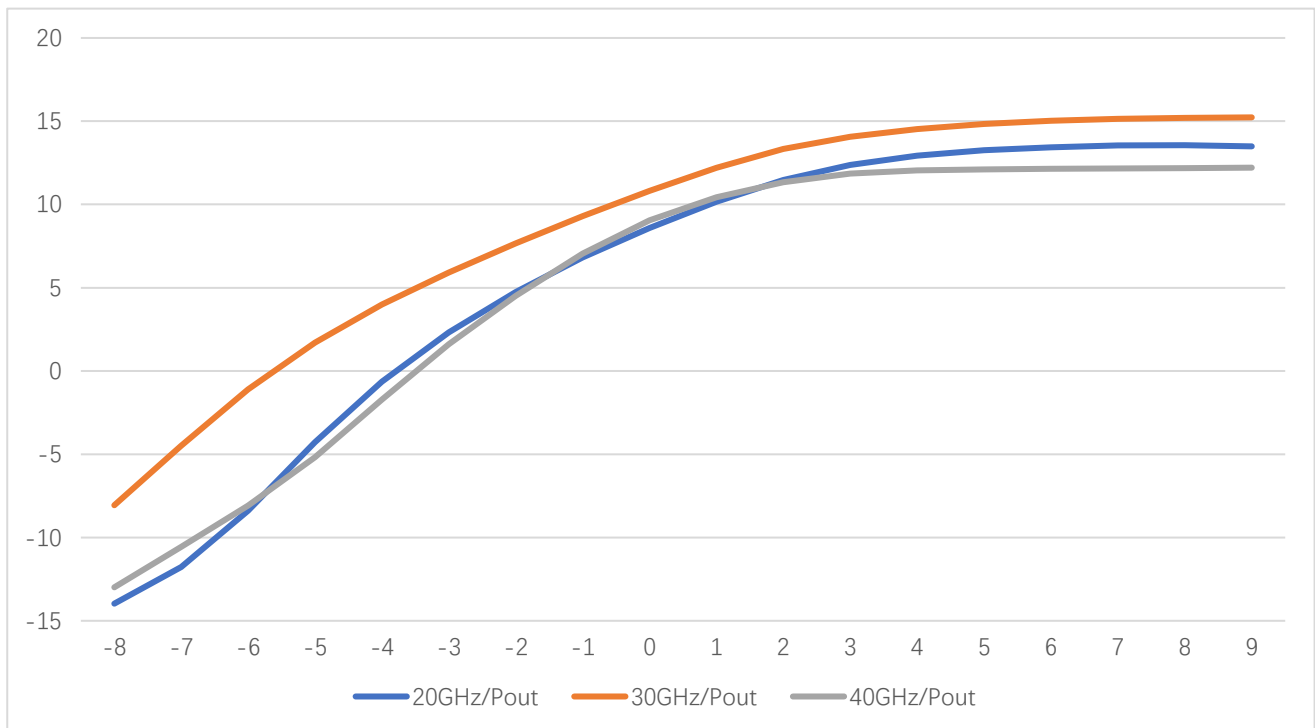

Pout vs Pin at 20/30/40GHz





AT-AM2-2040-15L

Active Multiplier x2, 20-40GHz Pout=+15dBm

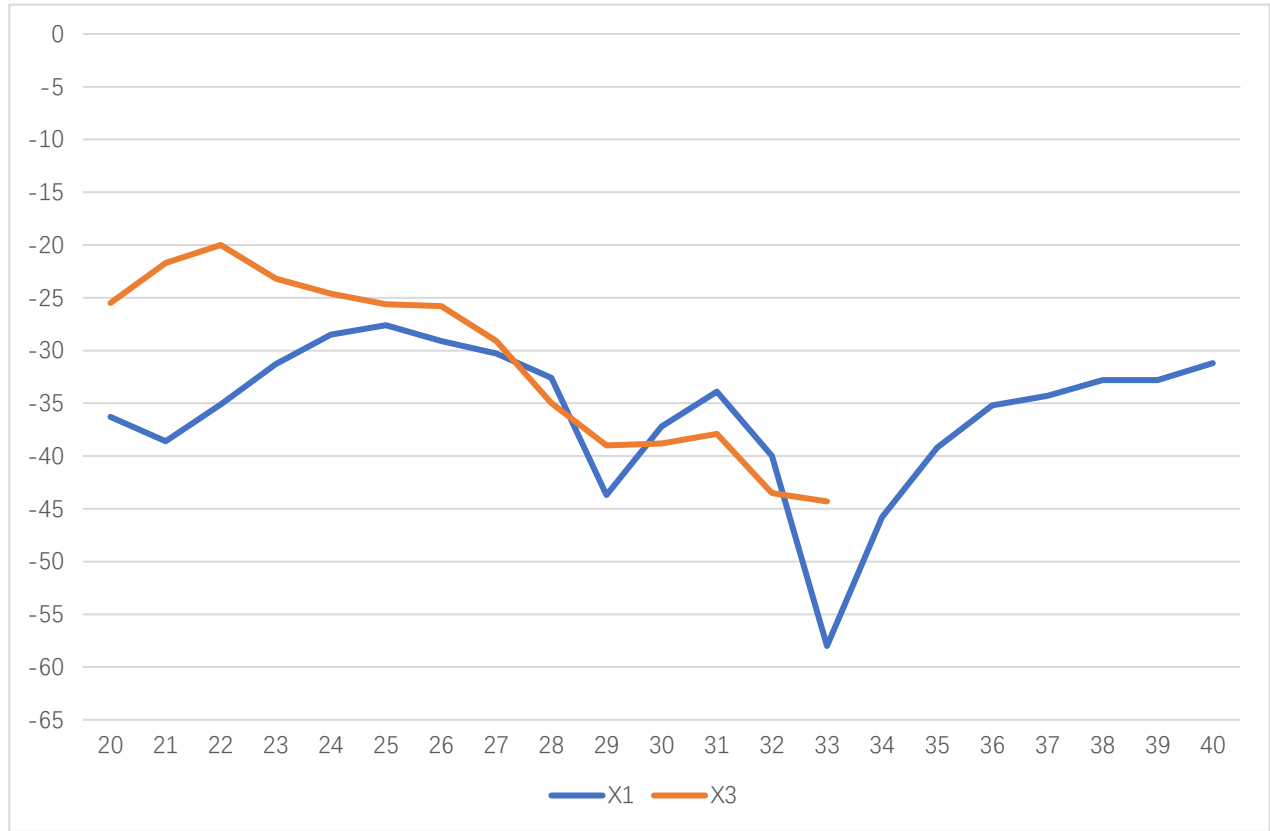

X1/X3 Harmonics vs X2 Pout



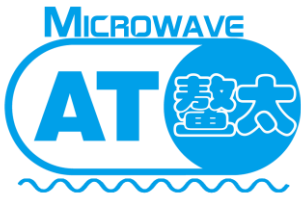

AT-AM2-2040-15L

Active Multiplier x2, 20-40GHz Pout=+15dBm

Dimension: (Unit:mm)

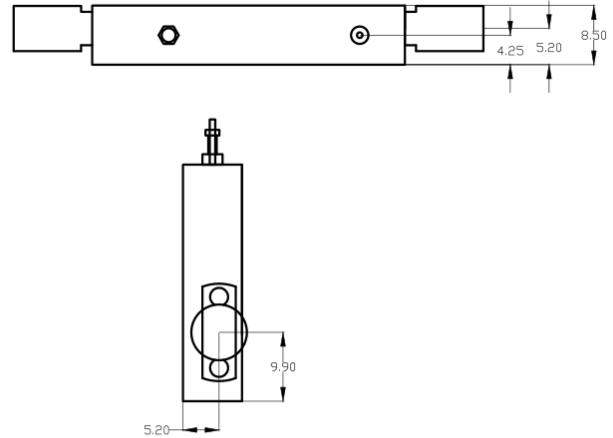
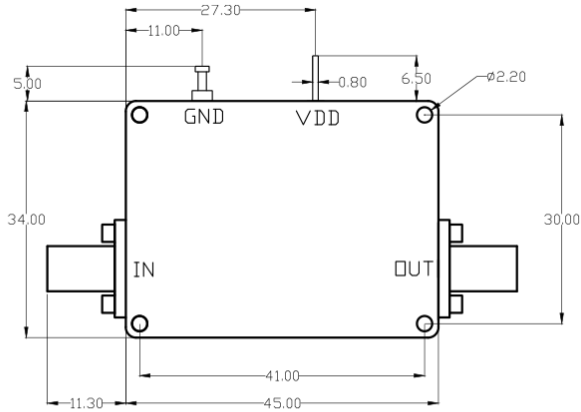

In millimetres

The 11.30 size marked is 1.85mm female connector

if use SMA female the size is 9.4 and 2.92mm female is 9.5

Heat Sink Required If Case Temp Higher Than 50C

